

OA-1.4V-2.3V/2585

Dual Band Omni Antenna

Key Features:

Designed for ground vehicle applications

Rugged design

Integral spring

Standard US/NATO 4 & 6 hole pattern

Single connector

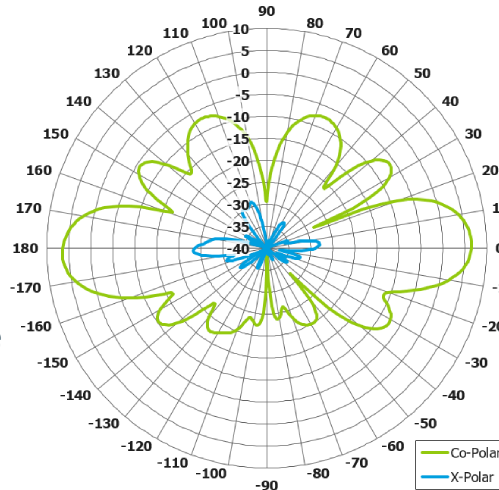

Elevation Polar Plot
(@ 1.37 GHz)

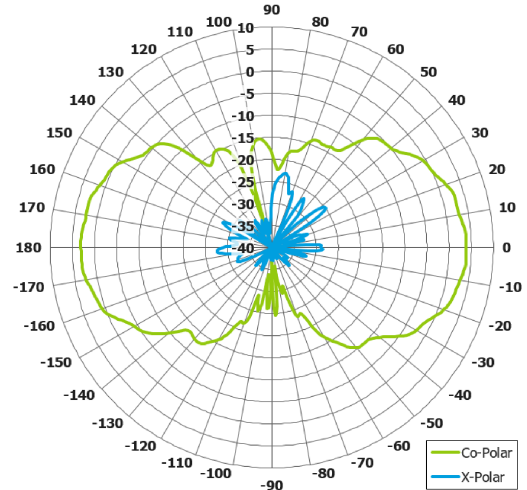

Elevation Polar Plot
(@ 2.35 GHz)

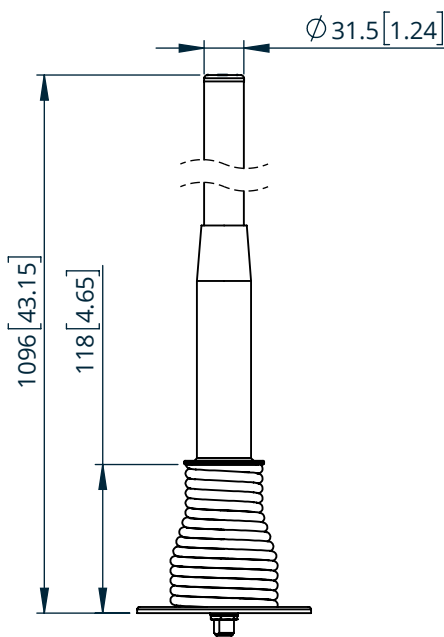

SIDE VIEW

MOUNTED VIA 4 OFF
 ϕ 11 [0.4] HOLES THRO'
EQUI-SP. ON 114.3 [4.5] PCD

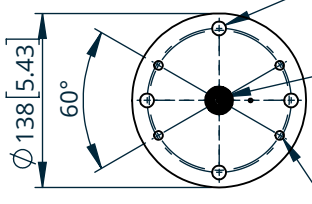

N(F) CONNECTOR

MOUNTED VIA 6 OFF
 ϕ 7 [0.3] HOLES THRO'
ON 111.1 [4.4] PCD

BASE VIEW

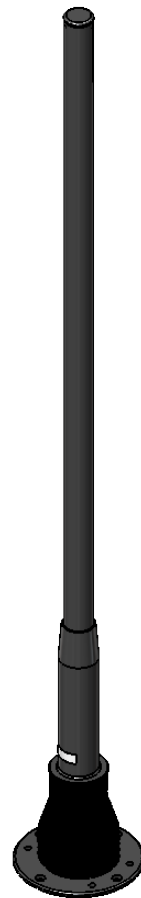

ELECTRICAL

| | | |
|------------------------|------------------|------------------|
| Frequency: | 1.35 to 1.39 GHz | 2.20 to 2.50 GHz |
| Gain (Peak): | 6.3 dBi Typ. | 3.8 dBi Typ. |
| Gain (Average): | 6 dBi Typ. | 3 dBi Typ. |
| Polarisation: | Vertical | Vertical |
| Beamwidth: | 360° x 20° Typ. | 360° x 43° Typ. |
| Azimuth Ripple: | ±0.3 dB Typ. | ±0.8 dB Typ. |
| Cross Polar: | >20 dB Typ. | >20 dB Typ. |
| VSWR: | 2:1 Max. | 2:1 Max. |
| Power Rating: | 10 W | 10 W |

MECHANICAL

| | |
|-------------------------|-------------------|
| Standard Finish: | Black |
| Mass: | 2.1 Kg / 4.63 lbs |
| Temperature: | -40 to +70°C |

MOUNTING OPTIONS

| | |
|------------------------|------------|
| Kits Available: | Integrated |
|------------------------|------------|

Full radiation patterns and CAD available on request

DS: 2585-2

Issued: 050922

Dimensions: mm [inches]